

BLOWER MOTOR INSPECTION

1. REMOVE GLOVE COMPARTMENT DOOR
(See page [BO-76](#))
2. REMOVE ENGINE (and ECT) ECU
 - (a) Disconnect the connectors.
 - (b) Remove the 2 bolts and engine (and ECT) ECU.

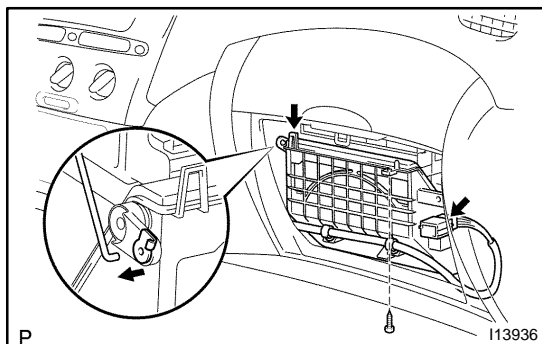

3. Two way flow heater models only:
REMOVE AIR DUCT (Motor cover)
 - (a) Disconnect the control link.
 - (b) Disconnect the connectors.
 - (c) Disconnect the connector clamps.
 - (d) Disconnect the wire harness clamps.
 - (e) Remove the screw.
 - (f) Release the claw and remove the air duct.

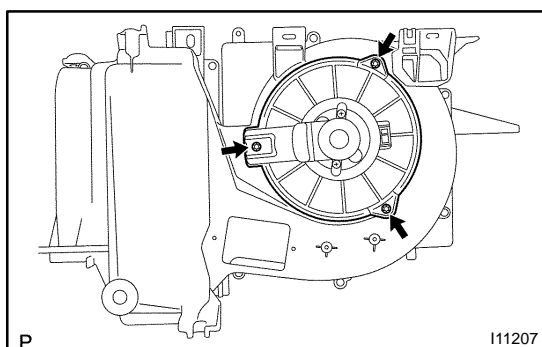

4. REMOVE BLOWER MOTOR
 - (a) Disconnect the connector.
 - (b) Remove the 3 screws and blower motor.

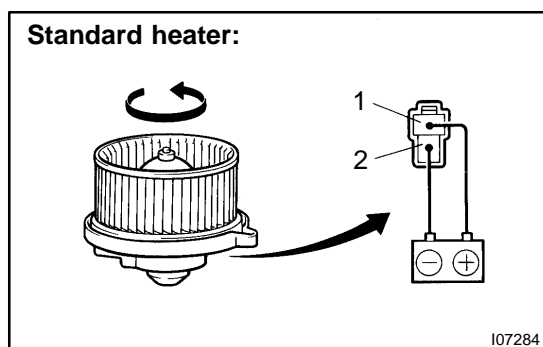

5. INSPECT BLOWER MOTOR OPERATION
Connect the positive (+) lead from the battery to terminal 1 and the negative (-) lead to terminal 2, then check that the motor operations smoothly.
If operation is not as specified, replace the blower motor.

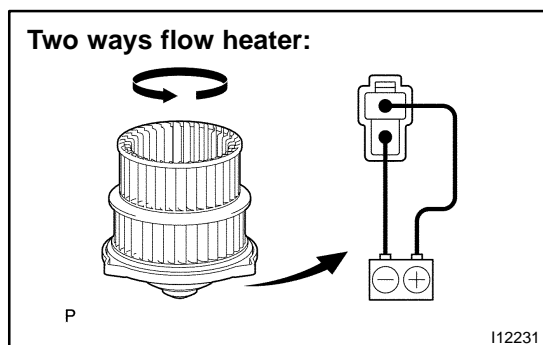

6. **INSTALL BLOWER MOTOR**
7. **Two way flow heater models only:
INSTALL AIR DUCT (Motor cover)**
8. **INSTALL ENGINE (and ECT) ECU**
9. **INSTALL GLOVE COMPARTMENT DOOR
(See page [BO-84](#))**