

DISASSEMBLY

1. REMOVE O/D MAIN SWITCH TERMINAL
 - (a) Remove the connector from the shift lever plate.

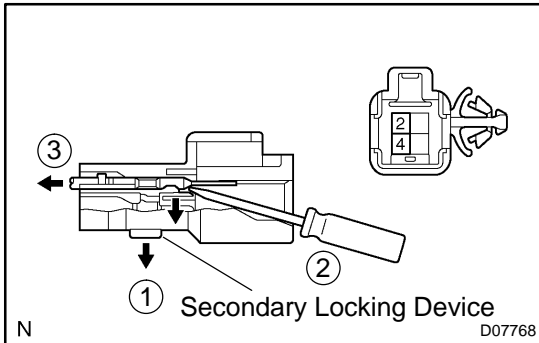

- (b) Remove the O/D main switch connector from the shift lever plate.
 - (c) Disengage the secondary locking device.
 - (d) Release the locking lug of the terminals 2 and 4, and pull the terminals out from the rearward.

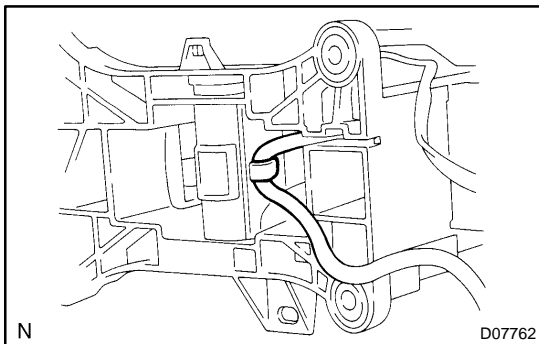

2. REMOVE SHIFT LEVER KNOB SUB-ASSEMBLY
 - (a) Remove the wire harness of the O/D main switch from the shift lever plate.

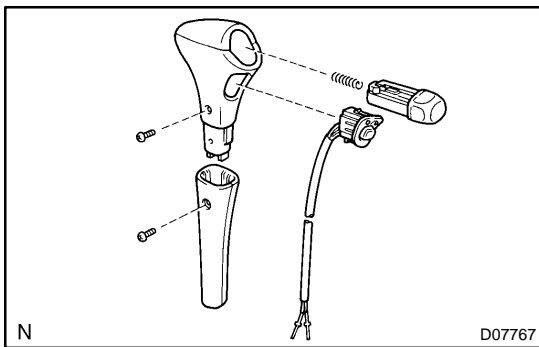

- (b) Remove the 2 screws and shift lever knob sub-assembly.
- NOTICE:**
Pay attention not to apply unnatural load to O/D main switch wire harness.
- (c) Remove the shift lever knob cover.
 - (d) Remove the shift lever button and spring.
 - (e) Remove the O/D main switch.

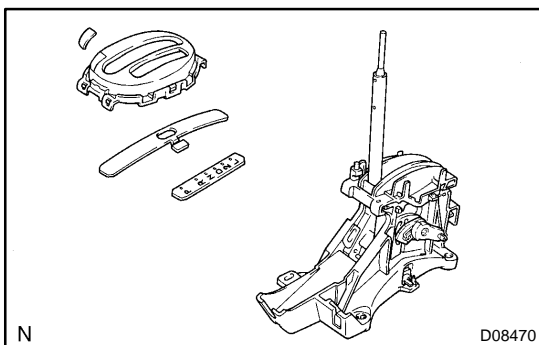

3. REMOVE POSITION INDICATOR HOUSING
 - (a) Remove the position indicator housing from the shift lever plate.
 - (b) Remove the cover from the position indicator housing.
 - (c) Remove the position indicator slide cover from the shift lever plate.
 - (d) Remove the position indicator plate from the position indicator housing.

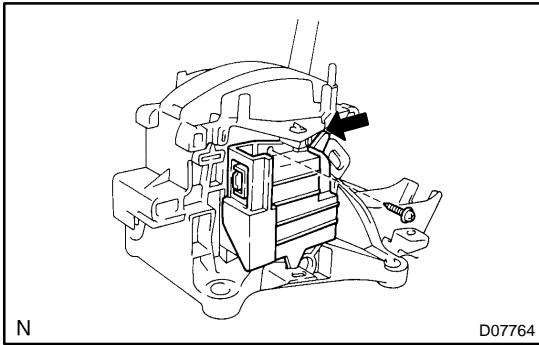

4. REMOVE SHIFT LOCK UNIT

(a) Remove the screw and shift lock unit.

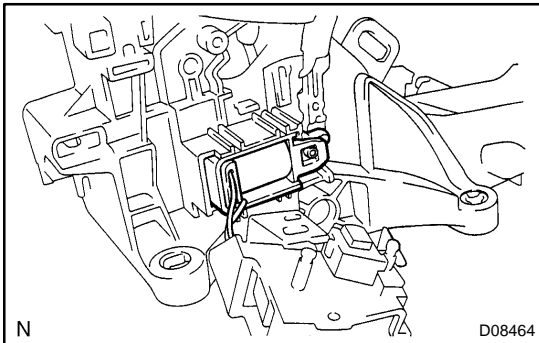

(b) Remove the solenoid from the shift lever plate.

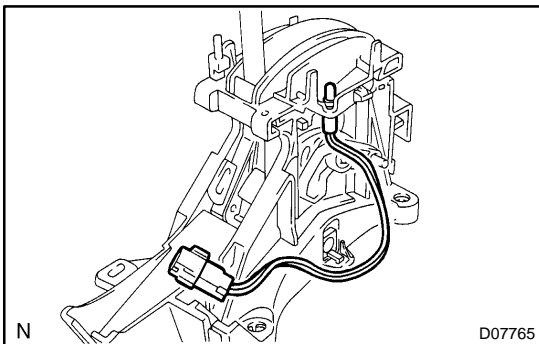

5. REMOVE INDICATOR LIGHT WIRE

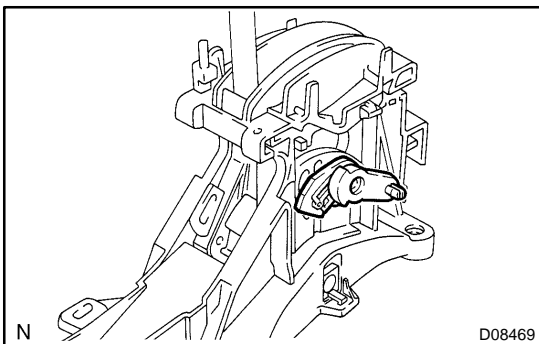

6. REMOVE KEY INTERLOCK CABLE ROD

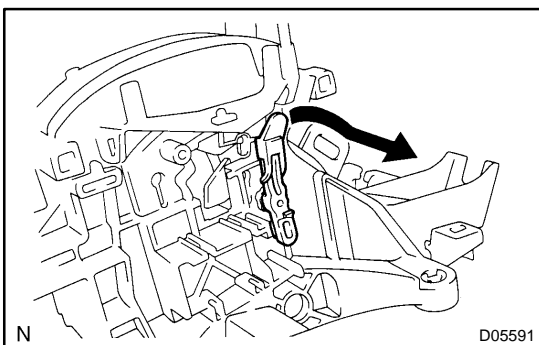

7. REMOVE SHIFT LOCK SOLENOID ROD

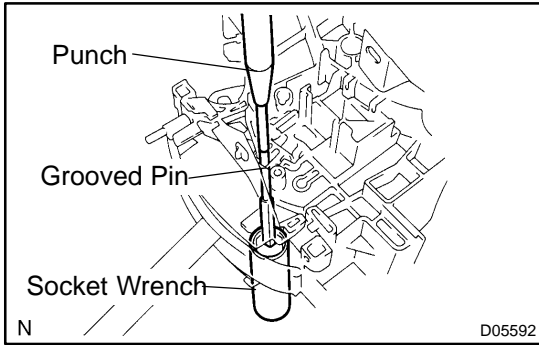

8. REMOVE SHIFT LEVER SUB-ASSEMBLY

- (a) Set a 14 mm deep socket wrench.
- (b) Using a punch and hammer, remove the grooved pin.
- (c) Remove the detent rod and spring.

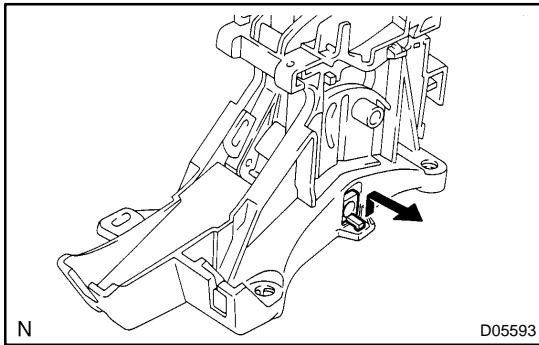

- (d) Using a screwdriver, remove the control shaft and shift lever sub-assembly.

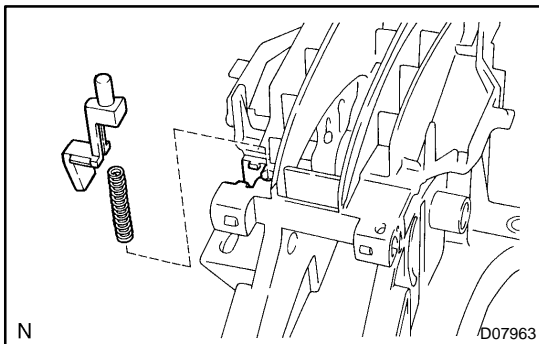

9. REMOVE SHIFT LOCK RELEASE BUTTON AND SPRING