

QUARTER PANEL (CUT)

REMOVAL

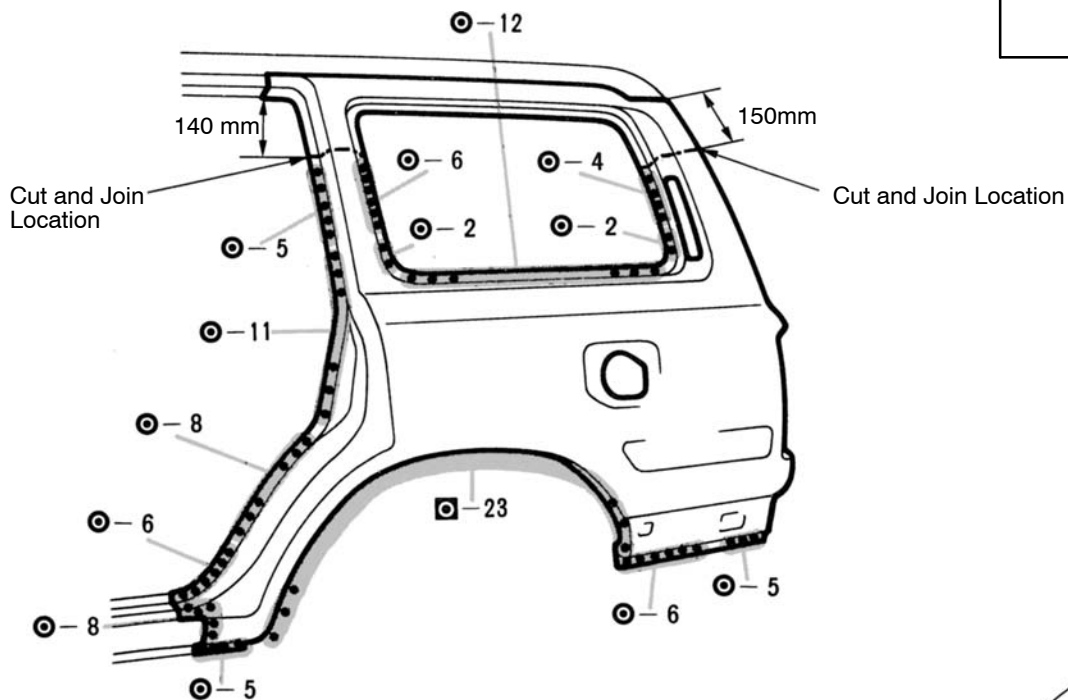

Cut and Join Location

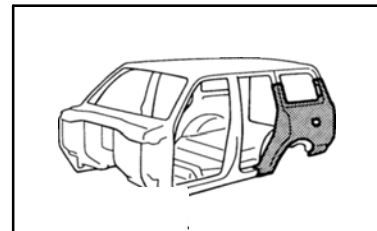
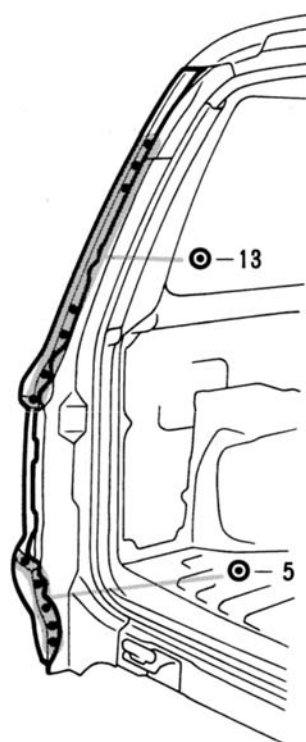
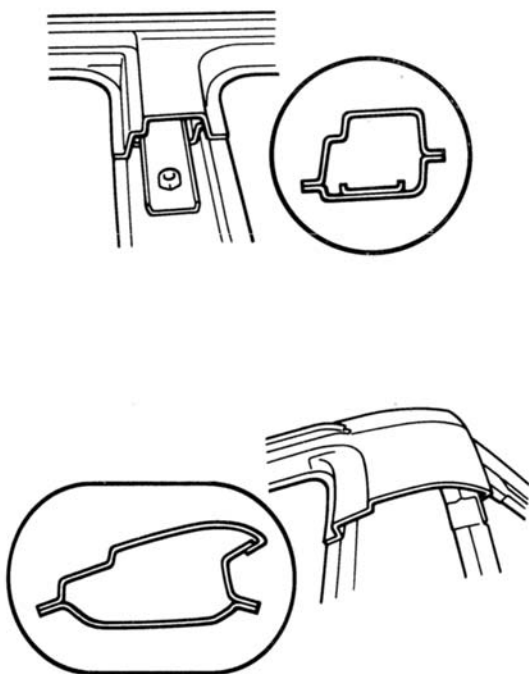

mm	in.
140	5.51
150	5.90

1. Cut and join the parts at the location shown above.

INSTALLATION

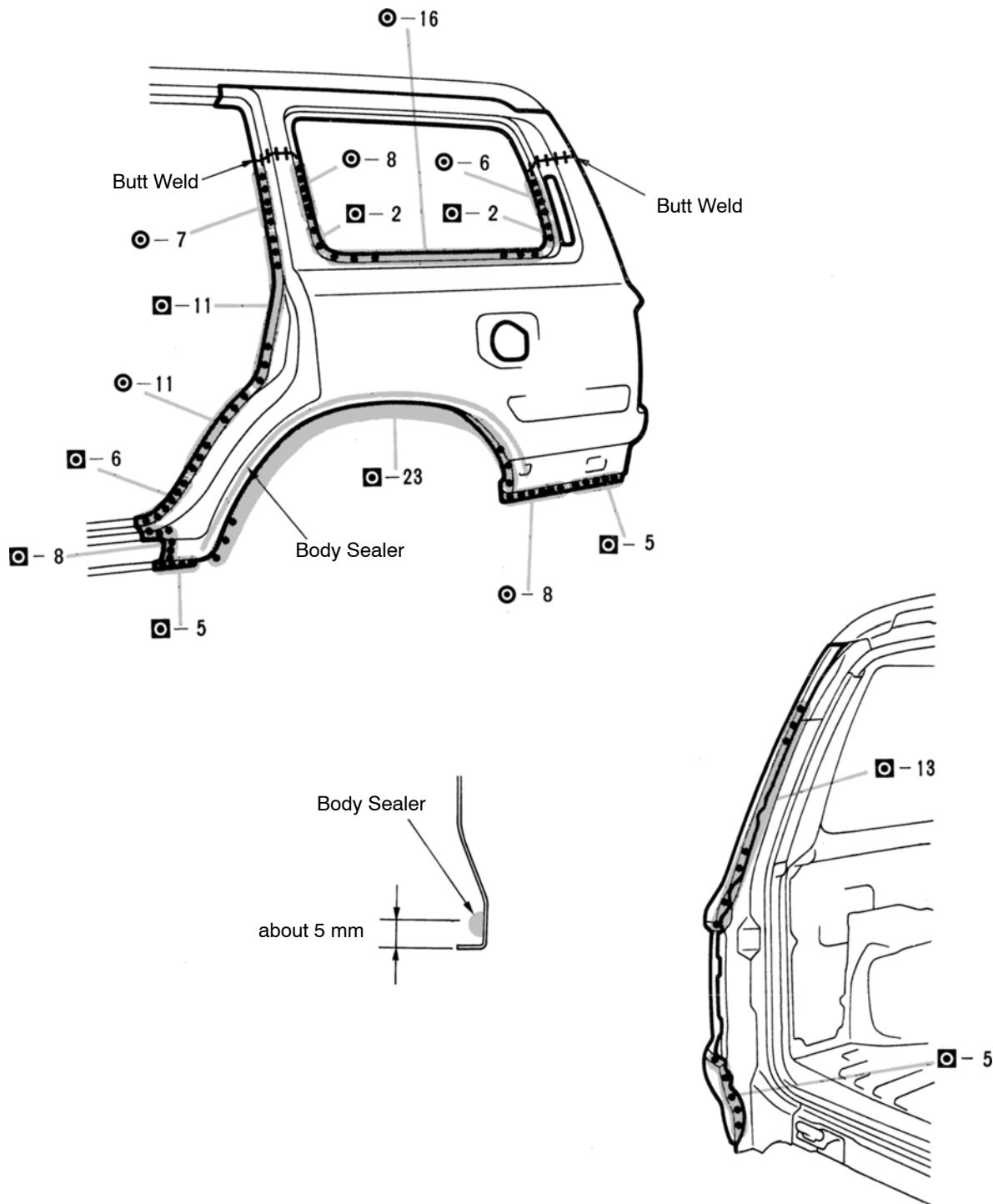

mm	in.
5	0.20

1. Before temporarily installing the new parts, apply body sealer to the wheel arch.

HINT:

- 1) Apply body sealer about 5 mm (0.20in.) from the flange, avoiding any oozing.
- 2) Apply sealer evenly, about 3 – 4 mm (0.12 – 0.16in.) in diameter.
- 3) For other sealing points, refer to section AR.

2. Temporarily install the new parts and check the fit of the rear door, back door and rear combination light.